

# Office to let

## Asirom Centre

Timișoara, Calea Aradului



### Building information

Building status	Existing
Year of construction	2000
Parking ratio	1 / 257 sq m
Total building area	11 255 sq m

### Commercial terms

Office space*	after login *
Parking	after login *
Service charge*	after login *
Minimum lease term	after login *
Availability	after login *

\* Asking terms for m<sup>2</sup>/month

### Location



### Available space

7 972 sq m

Available office space

20 sq m

Minimum office space

Typical floor plan

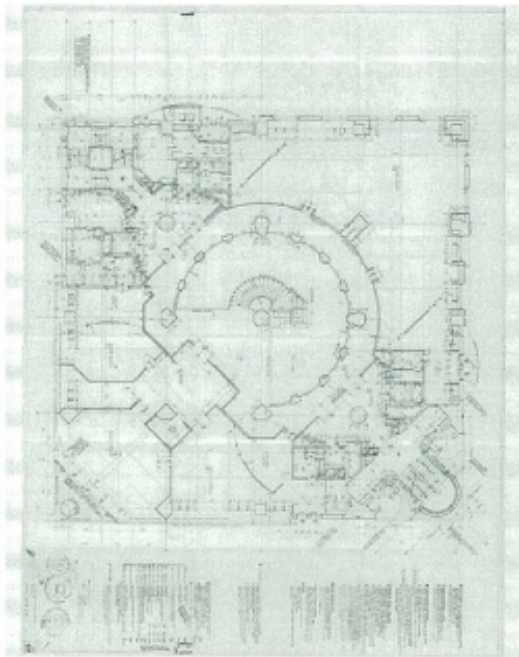

Available space

Floor	Vacant space	Availability
0	please contact us *	please contact us *
1	please contact us *	please contact us *
1	please contact us *	please contact us *
2	please contact us *	please contact us *
2	please contact us *	please contact us *
3	please contact us *	please contact us *
3	please contact us *	please contact us *
4	please contact us *	please contact us *
4	please contact us *	please contact us *
5	please contact us *	please contact us *
5	please contact us *	please contact us *
5	please contact us *	please contact us *
6	please contact us *	please contact us *
6	please contact us *	please contact us *
7	please contact us *	please contact us *

Contact

Available space

Floor	Vacant space	Availability
7	please contact us *	please contact us *
7	please contact us *	please contact us *
7	please contact us *	please contact us *
8	please contact us *	please contact us *
8	please contact us *	please contact us *
8	please contact us *	please contact us *
10	please contact us *	please contact us *
11	please contact us *	please contact us *
Total	after login *	

Public transport

Bus: E2, E6, 14, 17, 18, M14, M44

Contact

+40 21 302 3400

More information